

# STADIUM PLAZA

2001 – 2013 W. Worley St., Columbia, MO 65203



## Property Information:

- Located on Main Retail Corridor
- Adjacent to Columbia Regional Mall
- Total Center Size – 171,018 sq. ft.
- Traffic Count – 59,626 vehicles per day

## Demographics:

	3 miles	10 miles	30 miles
Estimated Population in 2016	56,391	149,531	315,046
Projected Population in 2020	59,822	160,337	329,485
Average Household Income	\$61,675	\$61,143	\$60,593
Median Household Income	\$44,016	\$43,609	\$46,135



## For More Information Contact:

Raul Walters Properties

Phone Number:  
314.584.1606 ext.2

Office Address:  
Two CityPlace Drive  
Suite 450  
St. Louis, MO 63141

# STADIUM PLAZA

2001 – 2013 W. Worley St., Columbia, MO 65203



Raul Walters  
PROPERTIES

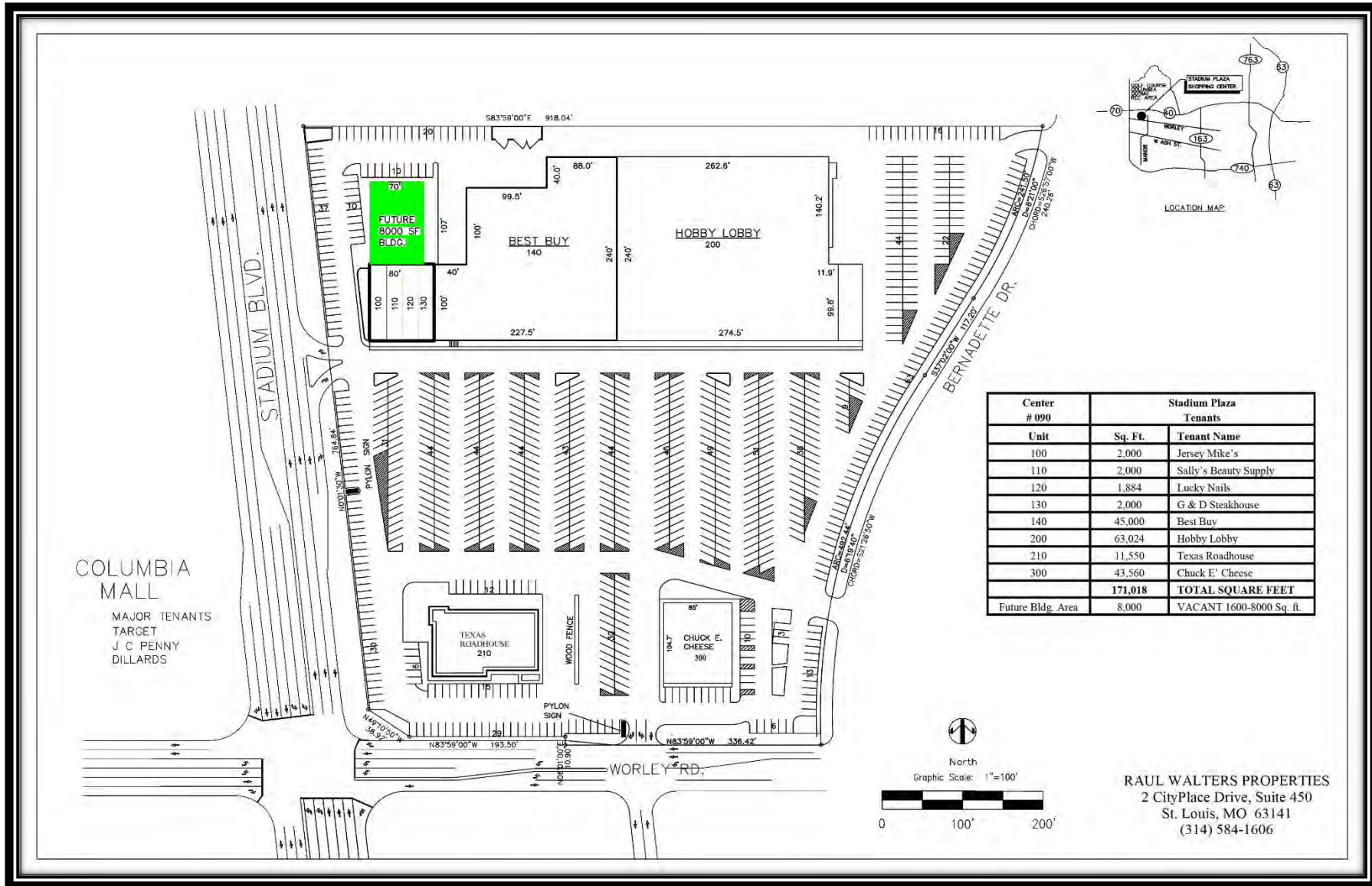

Center # 090	Stadium Plaza Tenants	
Unit	Sq. Ft.	Tenant Name
100	2,000	Jersey Mike's
110	2,000	Sally's Beauty Supply
120	1,884	Lucky Nails
130	2,000	G & D Steakhouse
140	45,000	Best Buy
200	63,024	Hobby Lobby
210	11,550	Texas Roadhouse
300	43,560	Chuck E' Cheese
	<b>171,018</b>	<b>TOTAL SQUARE FEET</b>
Future Bldg. Area	8,000	VACANT 1600-8000 Sq. ft.

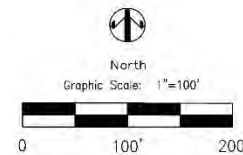

**RAUL WALTERS PROPERTIES**  
2 CityPlace Drive, Suite 450  
St. Louis, MO 63141  
(314) 584-1606

# STADIUM PLAZA

2001 – 2013 W. Worley St., Columbia, MO 65203



Raul Walters  
PROPERTIES



Disclaimer: The above information is based on current marketing conditions. No warranty or representation, expressed or implied, is made as to the accuracy of the information contained herein. Prospective customers should conduct their own due diligence. Raul Walters Properties shall not be responsible for any inaccurate information.